

# Video Borescope

**Model BR100**

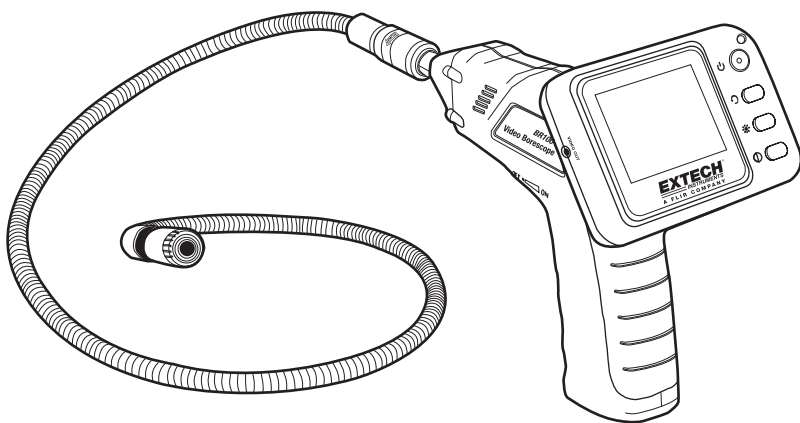

## ***Introduction***

---

Congratulations on your purchase of this Extech BR100 Video Borescope. This instrument was designed for use as an inspection device. It can be used to peer into tight spots and then supply real-time video and images. Typical applications include HVAC inspection, automotive inspection, cable routing, and automotive/boat/aircraft inspection. This meter is shipped fully tested and, with proper use, will provide years of reliable service. Please visit the Extech Instruments website ([www.extech.com](http://www.extech.com)) to check for the latest version of this User Guide.

## Description

---

- 1 Display
- 2 Handle/Battery compartment
- 3 Power On/Off, Dimmer
- 4 Flexible tube
- 5 Camera head and LED's

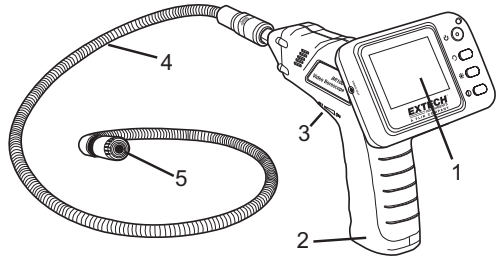

- 1 Power indicator
- 2 Display On/OFF
- 3 Power On/Off (side)
- 4 Image orientation
- 5 Brightness
- 6 Contrast
- 7 Video output
- 8 Handle connector (rear)

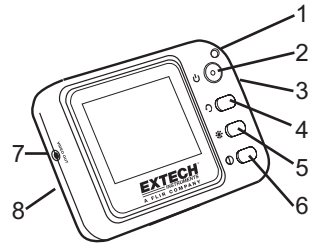

## Safety

---

- Do not expose instrument to moisture
- Shut off the instrument when not in use
- Remove the batteries when cleaning the instrument
- Replace all batteries at the same time

## Installation

---

Install the batteries into the instrument body, charge the monitor battery, connect the camera and flexible tube to the body, and install any accessory as needed.

### Battery Installation

1. Remove the screw and cover from the base of the handle.
2. Slide out the battery compartment.
3. Replace the four AA batteries observing polarity
4. Reinstall the battery compartment, cover and screw.

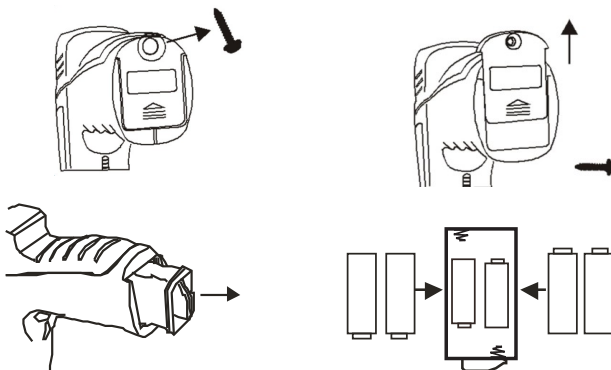

### Connect the camera and flexible tube

Connect the camera tube to the instrument body; ensure that the keyed ends are properly aligned. Once aligned, tighten the knurled knob to hold the connection firmly in place.

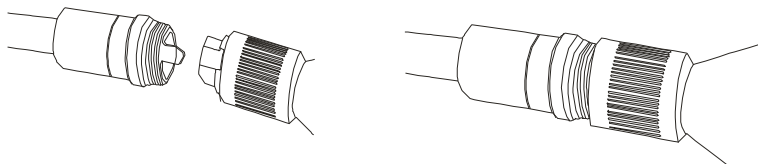

**Warning.** Permanent damage to the flex tube and loss of operation will occur if the flex tube is subjected to narrow radius or sharp angle bends.

## Attaching the Monitor to the instrument body

Insert the connector on the handle into the opening of the connector on the monitor and slide down until the monitor is firmly attached.

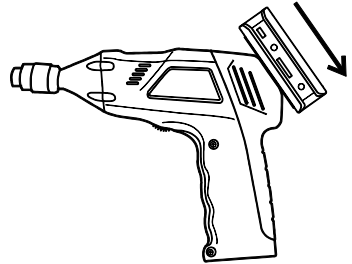

## Installing the accessory tools

The included accessories (mirror, hook and magnet) all attach to the camera in the same manner. Refer to the diagrams below:

1. Align the tool as shown in the diagram
2. Wrap the strap latch around the head and snap into place.

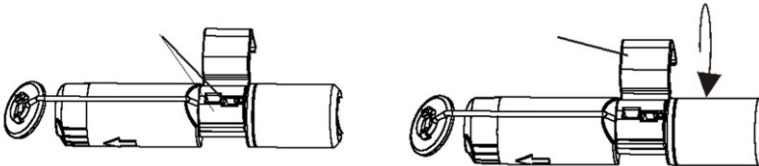

## Video Output

Insert the video cable into the VIDEO OUT socket on the monitor. Insert the other end of the cable into the VIDEO IN jack of a TV or other monitor. The LCD Monitor will output a high quality video image.

## Battery Replacement

---

When the battery icon appears on the LCD, the 'AA' battery must be replaced. The battery compartment is located on the bottom of the meter.

1. Press in and down on the arrow located above the tilt stand hinge.
2. Replace the 9V battery.
3. Replace the battery cover.

### Battery Safety Reminders

- Please dispose of batteries responsibly; always observe local, state, and federal regulations with regard to battery disposal.
- Never dispose of batteries in a fire. Batteries may explode or leak.
- Never mix battery types. Always install new batteries of the same type.

## Operation

---

1. Rotate the ON/OFF dial switch to power the camera. The power indicator on the top of the handle will switch on.
2. Further rotation of the switch adjusts the intensity of the two LEDs on the camera head.
3. Slide the On/Off switch on the side of the monitor to the ON position
4. Press the power button on the face of the monitor. The power light will turn on and the picture will appear.
5. Press the orientation button on the face of the monitor to rotate the picture as needed.
6. Press the brightness and contrast buttons in conjunction with the rotating the LED intensity for the best image quality.
7. The tube can be easily maneuvered into position. The tube can be bent into the shape of the area to be examined.
8. Use the supplied accessories to help retrieve small items.

## Charging the Meter

---

1. Place batteries into the handle of the meter.
2. Attach the monitor to the handle and slide the ON/OFF switch on the side of the meter to OFF.
3. Rotate the ON/OFF dial to power the camera. The power indicator on the top of the handle will switch ON.
4. The battery power from the handle will charge the monitor.
5. To save battery power: while charging the meter, remove the cable from the handle. This prevents the LEDs from lighting and consuming additional power.

## Specifications

---

### CAMERA

Imaging Sensor	CMOS
Total Pixels	712×486 (NTSC)
Horizontal View Angle	50 degree
Transmission Frequency	2468MHz
Minimum Illumination	0 Lux
Power Supply	4 x AA batteries
LCD Screen Type	2.36" TFT-LCD
Effective Pixels	480 x 234
Video Output Level	0.9-1.3VP-P@75Ω
Receiving Sensitivity	≤-85dBm
Dimensions (Monitor)	(W x D x H) 3.9 x 2.8 x 1.2" (100 x 70 x 30mm)
Operating Humidity (Max.)	15~85%RH
Waterproof Capacity	IP67 (imager head only)
Dimensions (Handle)	(W x D x H) 7.3 x 5.7 x 1.6" (186 x 145 x 41mm) (Excluding Flexible Tube)
Weight (approx)	15.5 oz. (440g)
Camera head Diameter	0.67" (17mm)
Operating Temperature	+14°F~-+122°F (-10°C~-+50°C)

## Warranty

---

*FLIR Systems, Inc. warrants this Extech Instruments brand device to be free of defects in parts and workmanship for one year from date of shipment (a six month limited warranty applies to sensors and cables). If it should become necessary to return the instrument for service during or beyond the warranty period, contact the Customer Service Department for authorization. Visit the website [www.extech.com](http://www.extech.com) for contact information. A Return Authorization (RA) number must be issued before any product is returned. The sender is responsible for shipping charges, freight, insurance and proper packaging to prevent damage in transit. This warranty does not apply to defects resulting from action of the user such as misuse, improper wiring, operation outside of specification, improper maintenance or repair, or unauthorized modification. FLIR Systems, Inc. specifically disclaims any implied warranties or merchantability or fitness for a specific purpose and will not be liable for any direct, indirect, incidental or consequential damages. FLIR's total liability is limited to repair or replacement of the product. The warranty set forth above is inclusive and no other warranty, whether written or oral, is expressed or implied.*

## Calibration, Repair, and Customer Care Services

---

FLIR Systems, Inc. offers repair and calibration services for the Extech Instruments products we sell. NIST certification for most products is also provided. Call the Customer Service Department for information on calibration services available for this product. Annual calibrations should be performed to verify meter performance and accuracy. Technical support and general customer service is also provided, refer to the contact information provided below.

**Support Lines: U.S. (877) 439-8324; International: +1 (603) 324-7800**

Technical Support: Option 3; E-mail: [support@extech.com](mailto:support@extech.com)

Repair & Returns: Option 4; E-mail: [repair@extech.com](mailto:repair@extech.com)

Product specifications are subject to change without notice

**Please visit our website for the most up-to-date information**

**[www.extech.com](http://www.extech.com)**

FLIR Commercial Systems, Inc., 9 Townsend West, Nashua, NH 03063 USA

**ISO 9001 Certified**

**Copyright © 2014 FLIR Systems, Inc.**

All rights reserved including the right of reproduction in whole or in part in any form

**[www.extech.com](http://www.extech.com)**

## Garantie

---

*FLIR Systems, Inc. garantit que cet appareil Extech Instruments est exempt de défauts matériaux et de fabrication pendant un an à partir de la date d'envoi (une garantie limitée de six mois s'applique aux capteurs et aux câbles). Si le renvoi de l'appareil pour réparation devient nécessaire durant ou après la période de garantie, contactez le service client pour autorisation. Pour obtenir les coordonnées, visitez le site Web suivant : [www.extech.com](http://www.extech.com). Un numéro d'autorisation de retour (AR) doit être délivré avant tout retour de produit. L'expéditeur prend à sa charge les frais d'expédition, le fret, l'assurance et l'emballage correct de l'appareil afin de prévenir toute détérioration durant le transport. Cette garantie ne s'applique pas aux dommages imputables à l'utilisateur, tels que l'usage impropre ou abusif, un mauvais câblage, une utilisation non conforme aux spécifications, un entretien ou une réparation incorrecte, ou toute modification non autorisée. FLIR Systems, Inc. déclinera spécifiquement toute garantie ou qualité marchande ou aptitude à l'emploi prévu, et ne sera en aucun cas tenu responsable pour tout dommage consécutif, direct, indirect ou accidentel. La responsabilité totale de FLIR est limitée à la réparation ou au remplacement du produit. La garantie définie ci-dessus est inclusive et aucune autre garantie, écrite ou orale, n'est exprimée ou implicite.*

## Calibrage, réparation et services après-vente

---

FLIR Systems, Inc. offre des services de calibrage et de réparation pour les produits Extech Instruments que nous commercialisons. Nous fournissons également une certification NIST pour la plupart des produits. Contactez notre service client pour toute information sur les services de calibrage disponibles pour ce produit. Un calibrage doit être effectué chaque année pour vérifier les performances et la précision du mètre. Nous offrons également une assistance technique et un service à la clientèle. Veuillez vous reporter aux coordonnées fournies ci-dessous.

**Lignes d'assistance: États-Unis (877) 439-8324; international: +1 (603) 324-7800**

Service d'assistance technique : Option 3 ; E-mail : [support@extech.com](mailto:support@extech.com)

Réparations et retours : Option 4 ; E-mail : [repair@extech.com](mailto:repair@extech.com)

Les spécifications produit sont sujettes à modifications sans préavis.

**Pour les toutes dernières informations, veuillez visiter notre site Web.**

**[www.extech.com](http://www.extech.com)**

FLIR Commercial Systems, Inc., 9 Townsend West, Nashua, NH 03063 USA

**Certifié ISO 9001**

**Copyright © 2014 FLIR Systems, Inc.**

Tous droits réservés, y compris la reproduction partielle ou totale sous quelque forme que ce soit.

**[www.extech.com](http://www.extech.com)**



## Garantía

---

*FLIR Systems, Inc., garantiza este dispositivo marca Extech Instruments para estar libre de defectos en partes o mano de obra durante un año a partir de la fecha de embarque (se aplica una garantía limitada de seis meses para cables y sensores). Si fuera necesario regresar el instrumento para servicio durante o después del periodo de garantía, llame al Departamento de Servicio a Clientes para obtener autorización. Visite [www.extech.com](http://www.extech.com) para Información de contacto. Se debe expedir un número de Autorización de Devolución (AD) antes de regresar cualquier producto. El remitente es responsable de los gastos de embarque, flete, seguro y empaque apropiado para prevenir daños en tránsito. Esta garantía no se aplica a defectos resultantes de las acciones del usuario como el mal uso, alambrado equivocado, operación fuera de las especificaciones, mantenimiento o reparación inadecuada o modificación no autorizada. FLIR Systems, Inc., rechaza específicamente cualesquier garantías implícitas o factibilidad de comercialización o idoneidad para cualquier propósito determinado y no será responsable por cualesquier daños directos, indirectos, incidentales o consecuentes. La responsabilidad total de FLIR está limitada a la reparación o reemplazo del producto. La garantía precedente es inclusiva y no hay otra garantía ya sea escrita u oral, expresa o implícita.*

## Servicios de calibración, reparación y atención a clientes

---

**FLIR Systems, Inc., ofrece servicios de reparación y calibración** para los productos que vendemos de Extech Instruments. Además ofrecemos certificación NIST para la mayoría de los productos. Llame al Departamento de Servicio al Cliente para solicitar información de calibración para este producto. Para verificar el funcionamiento y precisión se debe realizar la calibración anual. Además se provee Soporte Técnico y servicios generales al cliente, consulte la información de contacto en seguida.

**Líneas de soporte: EE.UU. (877) 439-8324; Internacional: +1 (603) 324-7800**

Soporte Técnico Opción 3; correo electrónico: [support@extech.com](mailto:support@extech.com)

Reparación / Devoluciones: Opción 4; correo electrónico: [repair@extech.com](mailto:repair@extech.com)

Las especificaciones del producto están sujetas a cambios sin aviso

**Por favor visite nuestra página en Internet para la información más actualizada**

**[www.extech.com](http://www.extech.com)**

FLIR Commercial Systems, Inc., 9 Townsend West, Nashua, NH 03063 USA

***Certificado ISO 9001***

**Copyright © 2014 FLIR Systems, Inc.**

Reservados todos los derechos, incluyendo el derecho de reproducción total o parcial en cualquier medio

**[www.extech.com](http://www.extech.com)**